

(1) SMR Code	(2) Federal Stock Number	(3) DESCRIPTION	(4) UNIT	(5) Qty	(6) 30-day DS maint	(7) 30-day GS maint	(8) 1-yr	(9) Depot	(10) Illustration	of inc. allowance	allowance	alw	maint		
										meas in Unit		per 100 equip	alw 100	per (a) Figure	(b) Item No.
		Reference Number & Mfr. Code	Usable On Code		(a)	(b)	(c)	(a)	(b)	(c)	gcy				
0900-PROPELLER SHAFTS-CONTINUED															
P-O	2520-734-8884	FLANGE COMPANION UNIVERSAL JOINT: TRANSFER TO PILLOW BLOCK 7348884 (19207)	A	EA	2	*	*	*	*	*	*	6	20	61	32
X2-O		SHAFT: PROPELLER 42-5788 (76260)	A	EA	1	*	*	*	*	*	*			61	33
P-O	2520-734-8892	SHAFT, ASSEMBLY: PROPELLER, TRANSFER TO FORWARD REAR AXLE WITH UNIVERSAL JOINT 7348892 (19207)	BE, IA, LA, MA, DA, DB, EA, EB, EC, IA, IB, DE, DF	EA	1	*	*	*	*	*	*	8	20	62	1
P-O	2520-040-2342	PROPELLER SHAFT: WITH UNIVERSAL JOINT, TRANSFER TO FORWARD REAR AXLE, OPTIONAL WITH SHAFT, FSN 2520-904-8105 8332247 (19207)	BE, IA, LA, MA, DA, DB EA, EB, EC, IA, IB, DE, DF	EA	1	*	*	*	*	*	*	8	20	62	1
P-O	2520-040-2341	SHAFT: PROPELLER TRANSFER TO FORWARD REAR AXLE WITH UNIVERSAL JOINT ASSEMBLY, OPTIONAL WITH SHAFT, FSN 2520-904-8106 8332246 (19207)	OB, BG, BE, CA, CB, FA, FB, BD, HA, IC, ID	EA	1	*	*	*	*	*	*	8	20	62	1
P-O	2520-904-8106	SHAFT, PROPELLER WITH UNIVERSAL JOINT: TRANSFER TO FORWARD REAR AXLE, WITH UNIVERSAL JOINT ASSEMBLY, OPTIONAL WITH SHAFT, FSN 2520-040-2341 8712094-2 (19207)	OB, BG, BF, CA, CB, FA, FB, BD, HA, IC, ID	EA	1	*	*	*	*	*	*	8	20	62	1
P-O	5310-950-0039	NUT, SELF-LOCKING HEAD: UNIVERSAL JOINT FLANGE MS21044N6 (96906)	A	EA	8	*	*	*	*	*	*	6	20	62	2
P-O	2520-734-8884	FLANGE: COMPANION, UNIVERSAL JOINT 7348884 (19207)	A	EA	2	*	*	*	*	*	*	4	10	62	3
P-O	5310-637-9541	WASHER, LOCK: BEARING JOURNAL MS35338-46 (96906)	A	EA	2	*	*	*	*	*	*	6	20	62	4
P-O	5306-737-6151	BOLT, MACHINE: UNIVERSAL JOINT FLANGE 7376151 (19207)	BE, IA, LA, MA, JA	EA	12	*	*	*	*	*	*	10	20	62	5
P-O	5306-737-6150	BOLT, MACHINE: UNIVERSAL JOINT FLANGE 7376150 (19207)	A	EA	2	*	*	*	*	*	*	6	10	62	6
X2-O		SHAFT: PL6317 (76260)	A	EA	1	*	*	*	*	*	*			62	7
P-O	3805-355-2100	RETAINER: PROPELLER SHAFT 7348886 (19207)	A	EA	1	*	*	*	*	*	*	6	10	62	8

Current part is item (1) on diagram. Available at www.oshkoshequipment.com

3-66

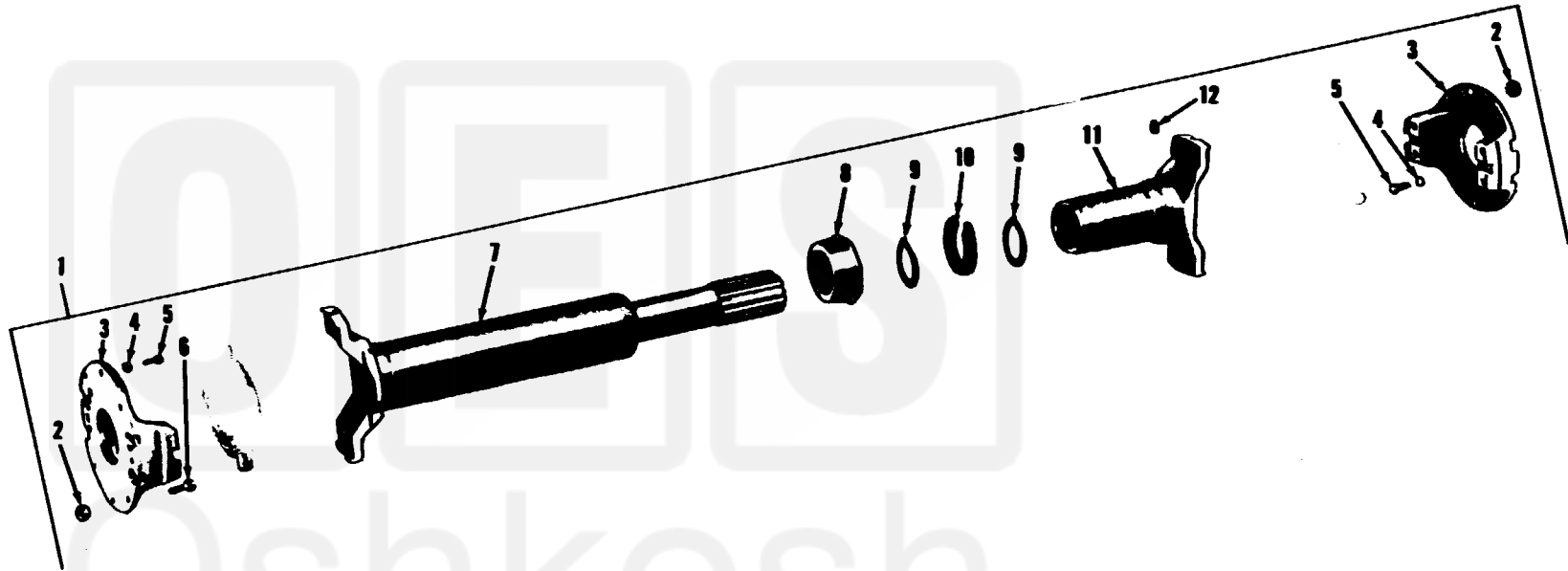

AT 47201

Figure 62. Propeller shaft assemblies transfer to forward rear axle and center bearing to forward rear axle.

Current part is item (1) on diagram. Available at www.oshkoshequipment.com

TM 9-2320-211-34P